

# 24 Ports Gigabit PoE+ Switch

13.238.101.1569  
V1.0

The 16/24 ports Gigabit PoE+ switch is an PoE switch along with 24\* 10/ 100/ 1000 Base-T downlink PoE ports and 2 \* 1000 Base-T uplink Ethernet ports featuring 30-watt 802.3at PoE+ as well as 2 additional Gigabit port. The total PoE power budget is up to 180/390 watts. The device can be widely used in video security monitoring systems, network projects, etc.

## Application

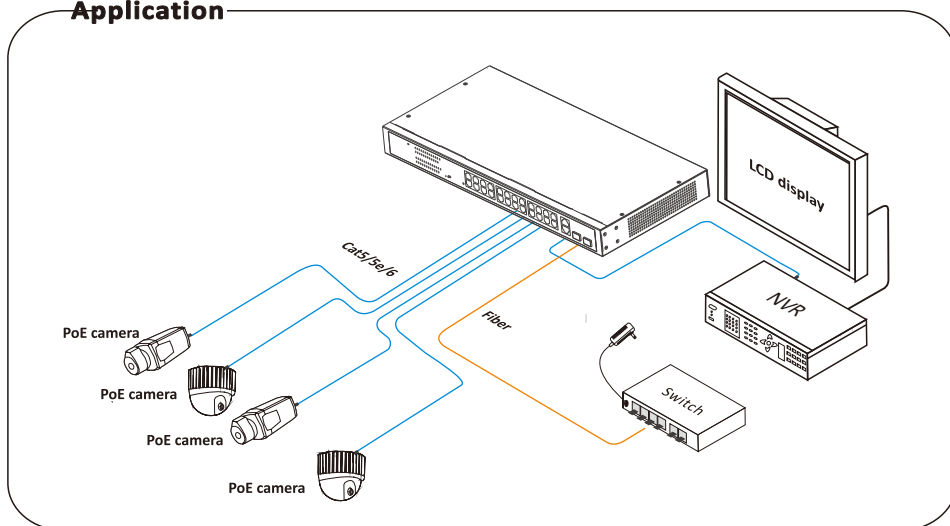

## Feature

- Provide 16/24\*10/100/1000Mbps downlink PoE Ethernet ports, 2\*gigabit uplink ethernet ports and 2\*gigabit fiber ports;
- Downlink ethernet ports support PoE+, each port supports max.30W output;
- Accord with IEEE802.3, IEEE802.3u, IEEE802.3ab, IEEE802.3 af/at standard;
- 8K MAC address, 4Mb cache;
- Quick installation, easy operation, convenient for wallmounted,desktop and rack installations.

## ! Notice

The transmission distance depends on the signal source and cable quality; standard Cat5e/6 Ethernet cable is strongly suggested for reaching the maximum transmission distance!

## Board diagram

### Front board

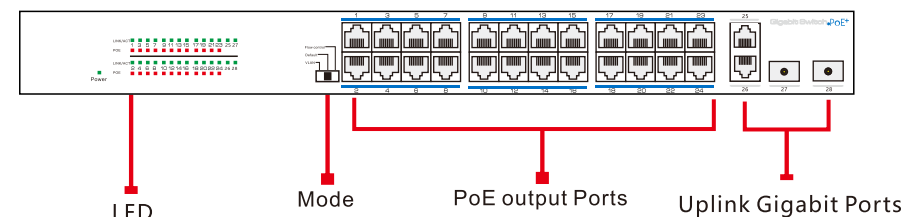

### Back board

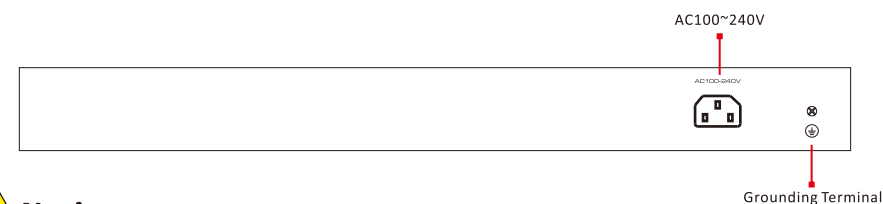

## ! Notice

- 1) Device must be connected with lightning protection grounding; otherwise protection level will be greatly reduced; please use above No.20 wire to connect the grounding terminal;
- 2) The device requires rebooting after the dial switch has been utilized.

## Installation steps

Please check the following items before installation, if it is missing, please contact the dealer.

- |                          |      |
|--------------------------|------|
| ● 16/24 Ports PoE Switch | 1pcs |
| ● AC Power Cable         | 1pcs |
| ● Accessories            | 1pcs |
| ● User Manual            | 1pcs |

### Please follow installation steps as below:

- 1) Turn off the power of all the related devices before the installation; otherwise the device would be damaged;
- 2) Use Ethernet cable connect PoE IP camera and 1~24 downlink ports of product respectively;
- 3) Use an Ethernet cable to connect equipment uplink port with NVR or computer;
- 4) Connect power adapter;
- 5) Check if the installation is correct, equipment is in good condition, the connection is stable, then power on for system.

## ■ Specification

Item	Description		
Product Type		SW-24POE-S2	
Downlink Etheernet Ports	24*10/100/1000Base-T PoE+		
Uplink Ethernet Ports	2*10/100/1000Base-T + 2*1000Base-X(SFP)		
Network Standard	IEEE 802.3/802.3u/IEEE802.3ab/IEEE802.3z/IEEE802.3x		
Exchange Capacity	56Gbps		
Packet Transfer Rate	42Mpps		
Exchange method	Store and Forward switching		
Packet Data Cache	4M		
MAC Address	8K		
PoE Power Supply	End-span(1/2, 3/6) , IEEE802.3af/at		
Single Port Power Output	Single port PoE power output ≤ 30W(54V DC)		
PoE Max. Power Output	390W		
Operating Mode	Default:All ports can communicate with each other;		
	Vlan: 1.Downlink ports only communicate with uplink ports; 2.Restrict network storm under 2Mbps;		
	Flow control: Switch flow control function is turned off, this mode is suitable for video surveillance transmission		
Lightning Protection	6KV; Execute: IEC61000-4-5		
ESD	6KV Contact discharge 8KV Air discharge Execute: IEC61000-4-2		
Power Supply	100~240V AC; 50/60Hz		
Work Temperature	0°C~+40°C		
Storage Temperature	-40°C~+85°C		
Humidity(Noncondensin)	5%-95%		
Dimension(L*W*H)	442mm×285mm×44mm		
Weight	3 kg		

Product specifications subject to change without prior notice.

## ■ Trouble shooting

If any trouble in installation, please follow these steps:

- Please make sure you have followed the instruction to install the device;
- Please confirm if the RJ45 cable order is in accordance with the EIA/TIA568A or 568B industry standards;
- The power supply of each PoE port is no more than 30W;
- Please do not connect the PoE device which exceeds the maximum PoE power supply;
- Please replace a failure device with a proper one to check if the device is broken.

## ■ Installation Way

There are 3 installation ways: rack, workbench and wall-hung installation.

### Rack Installation process:

- (1) Check rack grounding and stability;
- (2) Use screws to fit hangers at the device board side;
- (3) Put the device on the rack's bracket and move the rack along the slot to proper position ;
- (4) Use screws to fit the installation hanger at rack's fixed slot, make sure the device is installed at rack's bracket steadily.

### Workbench Installation process:

- (1) Put the device upside down carefully, clean the grooves on the chassis backplane with soft cloth to make sure there is no oil or dust in it;
- (2) Remove the stickers on the foot pad, paste the foot pad in backplane groove;
- (3) Put the device upright on the workbench.

### Wall-hung Installation process:

- (1) Use the screws to fix the hangers;
- (2) Drill holes on the solid position of wall and then drive the rubber plug into the hole;
- (3) Drive these screws into the hole for the rack and fix the product by aiming at the rubber plug.



Install hangers diagram

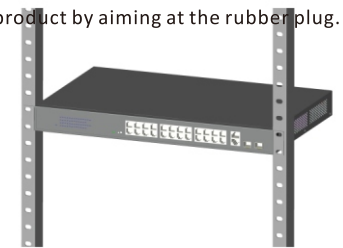

Install switch to the rack



Please pull out the power line before installing or moving the switch. Grounding and anti-lightening can greatly increase the protection level of the switch. please connect the earth terminal to the earth by using at least wire 20.